

KOALA

L I V I N G

Assembly Instruction

Product Name: Costanza Mocha Walnut Brown Wooden Bedside Table

Product Id: 130444

Hardware List

A



Allen Key
4mm 1 pc

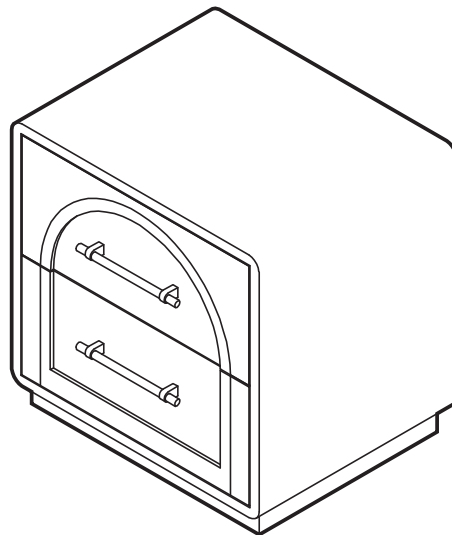

Part List

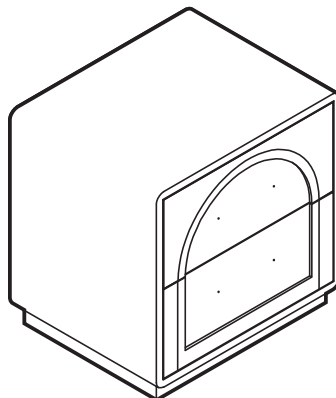

Bedside Table
1 pc

Note

1. Assemble the item on a soft, well-lit surface like cardboard or carpet.
2. For safety and efficiency, it's best to have two or more people assist with assembly to handle heavy parts safely and collaborate effectively.
3. Keep all packaging materials intact until assembly is complete.
4. Before assembling the item, carefully read all provided instructions.
5. Handle tools with care during assembly to prevent injuries.

1

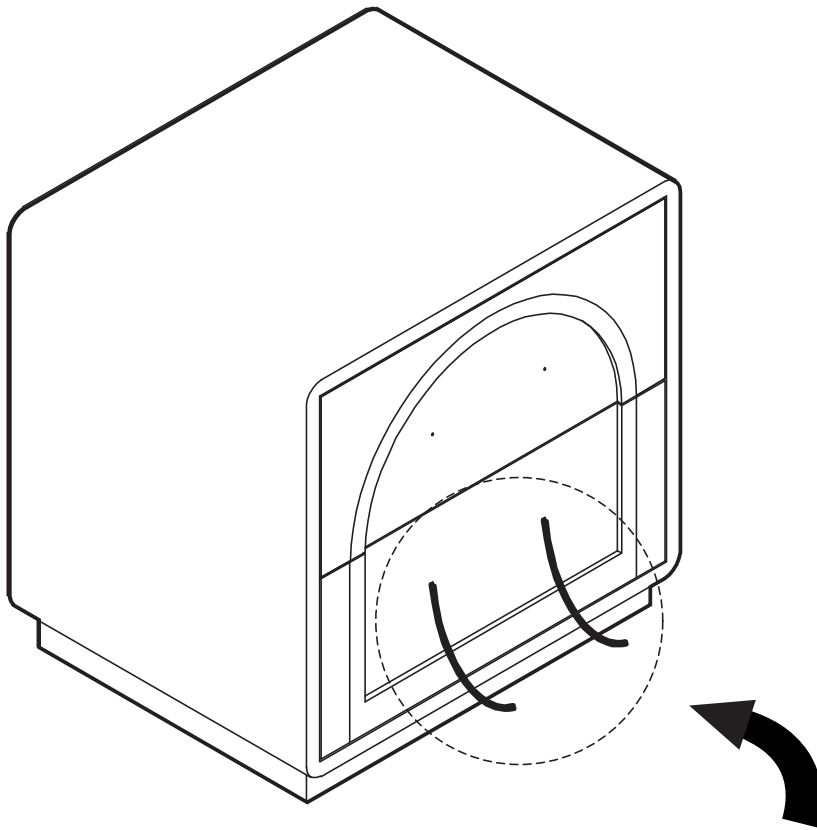

The red rope is used to help open the drawer, as the door handles are stored inside. Once the handles are assembled, you can discard the red rope

2

unscrew

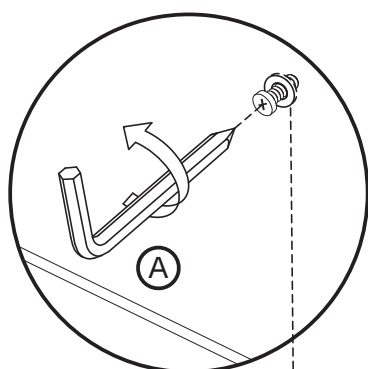

Please throw away this rubber piece.
Do not assemble this rubber piece.

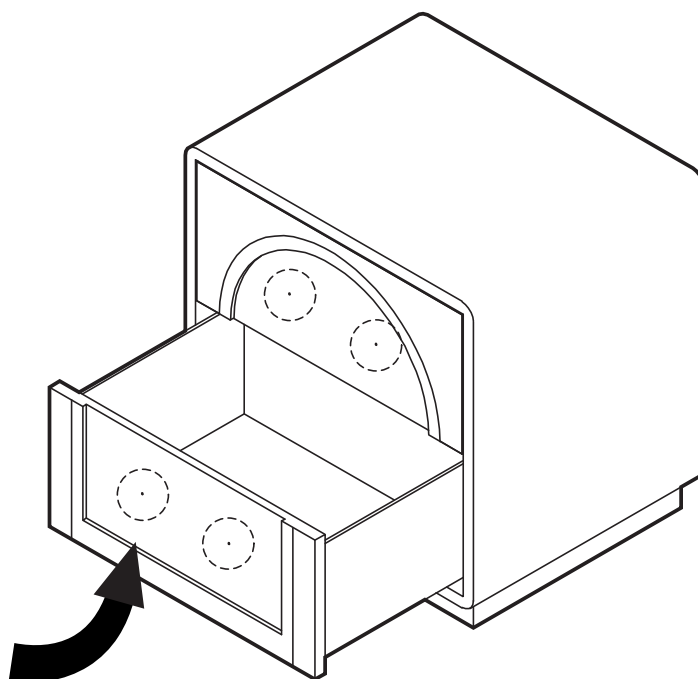

3

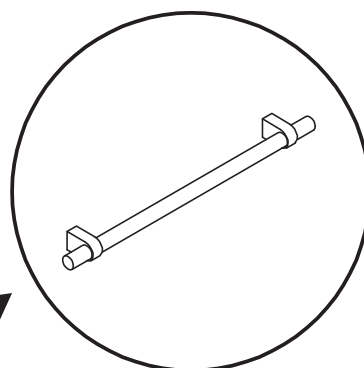

unscrew
to get handle

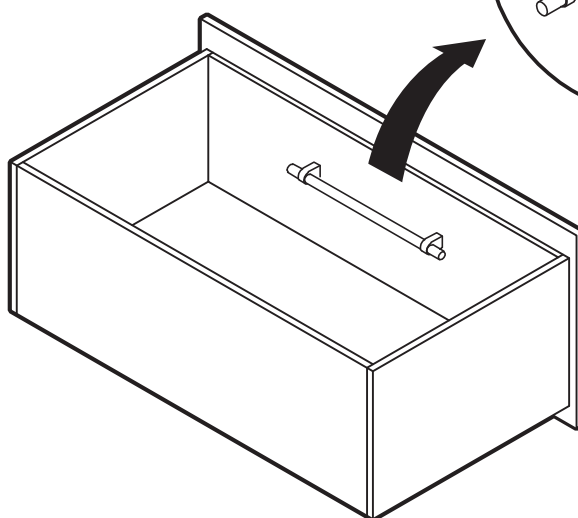

4

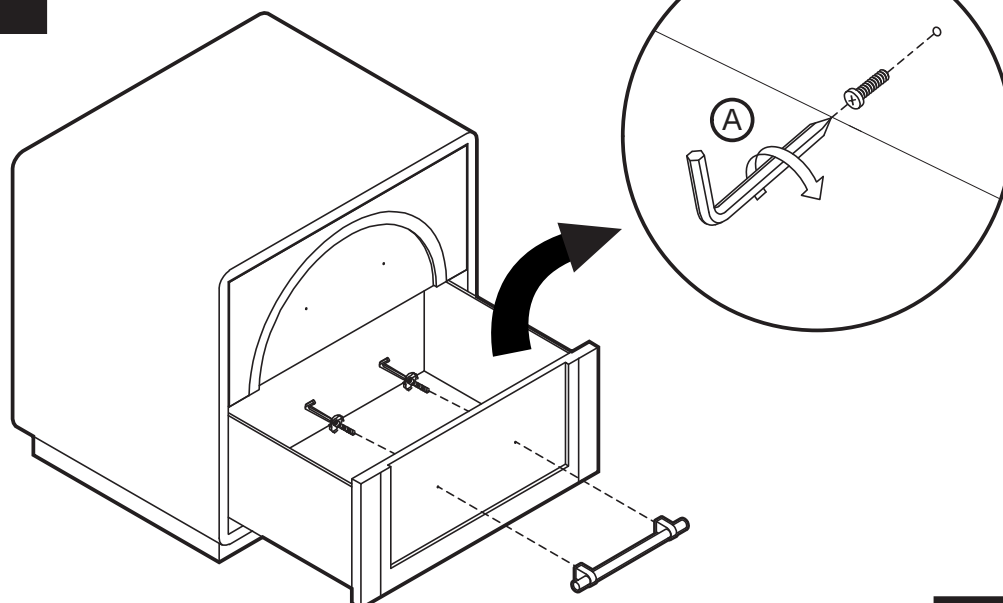

5

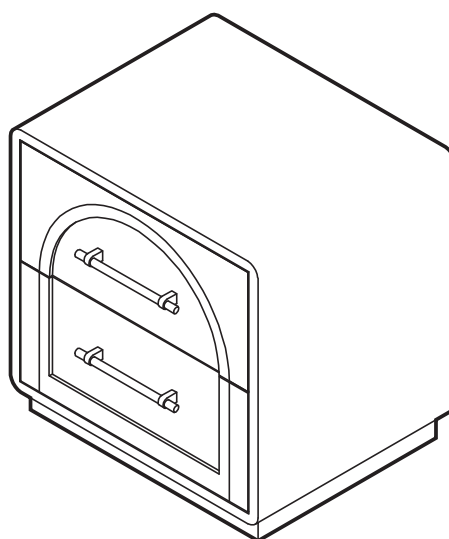

⚠ Warning

1. Always secure this furniture with an anchor device
2. Never allow children to stand, climb or hang on drawers, doors, or shelves
3. Never open more than one drawer at a time
4. Place heavy items down low

